

## Key

 Existing "No waiting at any time" (double yellow lines)

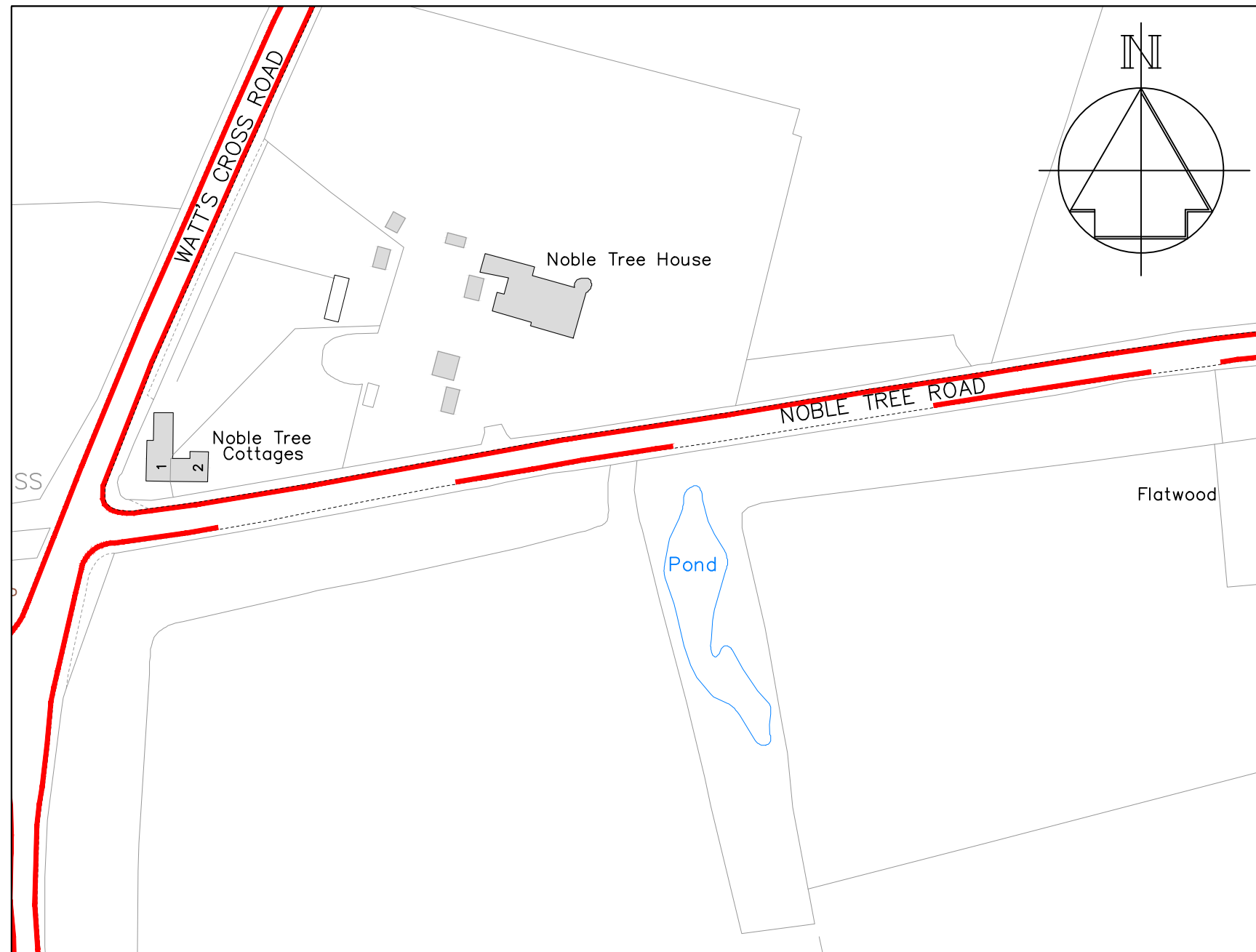
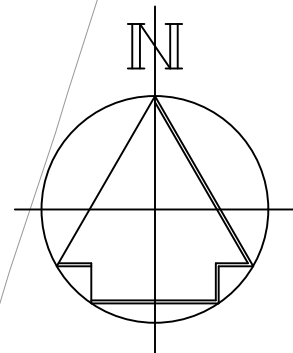

A	Revised to formal consultation	5/2023
	Revision	Date

Drawn	Checked	Date
ACB	AE	12/2022

Scale 1 :1250 @ A4

Drawing No.	Rev
DD/588/15	A



STREETSCENE,  
LEISURE &  
TECHNICAL SERVICES

Transportation Team  
Gibson Building  
Gibson Drive  
Kings Hill  
West Malling  
Kent ME19 4LZ  
Tel: 01732 844522

Project Title  
Hildenborough Parking Review  
Formal consultation

Drawing Title  
Noble Tree Road (west) and  
Watt's Cross Road